



EL3000HD Series

HEAVY DUTY MORTISE LOCKS

The EL3000HD series mortise locks are renowned for their exceptional quality and reliability. We prioritize the use of high-grade materials and employ precise production procedures, all backed by a stringent quality management system. These locks are designed to meet rigorous technical specifications, ensuring optimal performance. They have undergone extensive testing to comply with international standards, including rigorous testing of 2 million cycles.

Equipped with a comprehensive range of functions, these locks are tailored to meet your specific requirements. Additionally, the locks feature a SUS316 forend and strikeplate to prevent corrosion and provide a polished finish for your door.



Features

- **Exceptional quality and reliability** - Utilizing high-grade materials, including a SUS316 forend and strikeplate which offer enhanced resistance to corrosion while maintaining a polished appearance for your door
- **Heavy duty** - Undergone an additional rigorous testing of 2 million cycles by TUV SUD
- Offers a comprehensive selection of **7 functions** to accommodate various project requirements
- **Enhanced security** - Undergone extensive testing to meet the highest EN12209 grade standards, providing the utmost level of security for your premises

Types of mortise locks

1. **EL3010HD Mortise Deadlock**
Mortise deadlock is suitable for most interior door that does not need to be latch. e.g. public toilet. The deadbolt is thrown or retracted from one or both sides.
2. **EL3020HD Mortise Sashlock**
Mortise sashlock is suitable for most door require locking function. The latch bolt is retracted from both sides by lever handles. Depending on the cylinder selected, the deadbolt can be thrown or retracted from one or both sides.
3. **EL3030HD Mortise Bathroom**
Use for interior bathroom door. The deadbolt is thrown or retracted by turning the thumbturn. An indicator cover consisting an indicator and an emergency release device is available on the outside lever.
4. **EL3040HD Mortise Passage**
Application mainly for staircase or door that do not need to have cylinder to lock the door. The latch-bolt is activate by the lever handle. The door remain unlock unless Electromagnetic (EM) lock are used in this instance.
5. **EL3050HD Mortise Nightlatch**
Mainly use for 1 side escape door, storeroom or staircases. Latchbolt is retracted by key outside or by lever inside. Outside lever is always in-operative. Guard latch deadlocks latchbolt when the door is closed.
6. **EL3060HD Mortise Panic Lock**
Commonly used for maindoor, office door, this lock allow use to retract both the latch and deadbolt with one single action. Deadbolt thrown or retracted by inside lever and cylinder. Lock functions on both sides are field reversible.
7. **EL3070HD Mortise Classroom Lock**
The classroom lock are commonly used in classroom to prevent student from locking inside. The lock can be turn to a passage mode with turning of the cylinder. Lockcase has latchbolt and auxiliary guard latch, no deadbolt. Outside lever can be locked or unlocked by cylinder. Latchbolt is operated by unlocked outside lever and by inside levers all the time. Auxiliary guard latch deadlocks latchbolt when door is closed.

Escape Functions

Escape function locks for example panic lock and classroom lock are designed so that they can be operated by a single action on the lever, in the direction of the escape route, which will withdraw the latchbolt and the deadbolt simultaneously to give immediate escape.

Escape locks are certified for use with specific lever furniture which has been assessed as suitable for use in an emergency application. The furniture is supplied with special split spindles which allow the internal and external handles to operate independently

Technical specifications

Model	EL3010HD	EL3020HD	EL3030HD	EL3040HD	EL3050HD	EL3060HD EL3060HD-AT	EL3070HD
Product Name	Mortise Deadlock	Mortise Sashlock	Mortise Bathroom	Mortise Passage	Mortise Night-latch	Mortise Panic Lock Mortise Panic Lock Anti-Thrust	Mortise Classroom Lock
Compliance	EN12209:2016 3X810G6HA00	EN12209:2016 3X810G6HA20	EN12209:2016 3X810G-HG20	EN12209:2016 3X810G-H020	EN12209:2016 3X810G2HB20	Pending	Pending
Center to Center	NA	72mm	78mm	NA	72mm	72mm	72mm
Deadbolt	Single throw 20mm	Single throw 20mm	Single throw 20mm	NA	NA	Single throw 20mm	NA
Latchbolt	NA	12.5mm					
Backset	55mm / 60mm / 70mm						60mm / 70mm
Corrosion	240H salt spray test (for SUS316 finish)						
Finishes	SUS304 or SUS316 (forend and strikeplate)						
Dimension Compliance	DIN18251						
Faceplate Dimension	235mm (H) / 24mm (W) / 3mm (D)						

Dimensions

EL3010HD

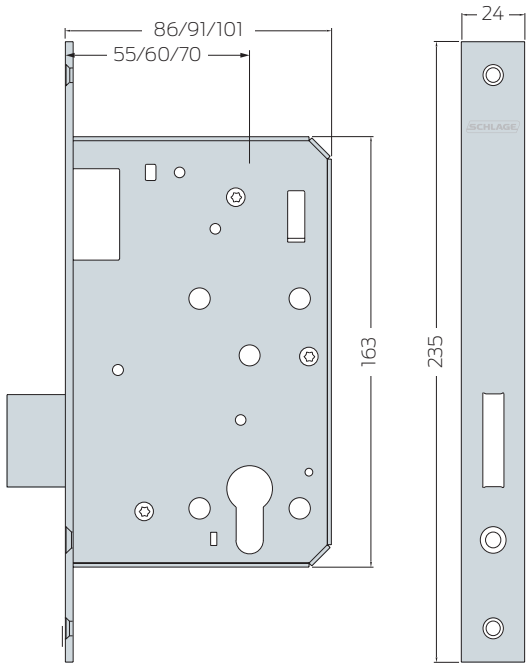

EL3020HD

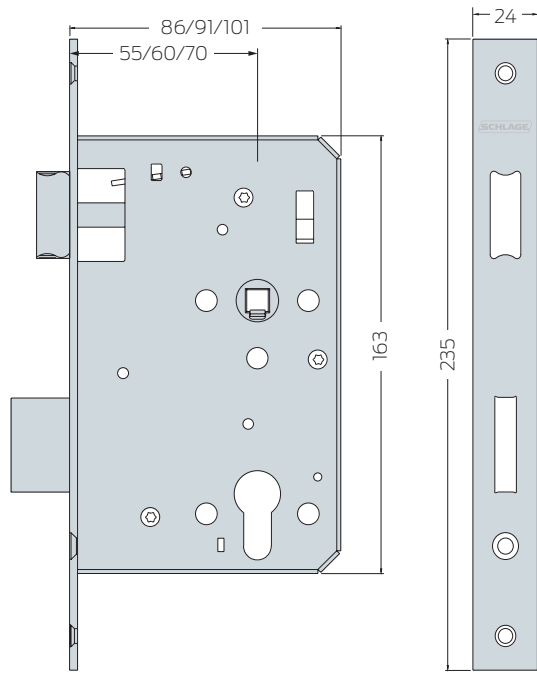

EL3030HD

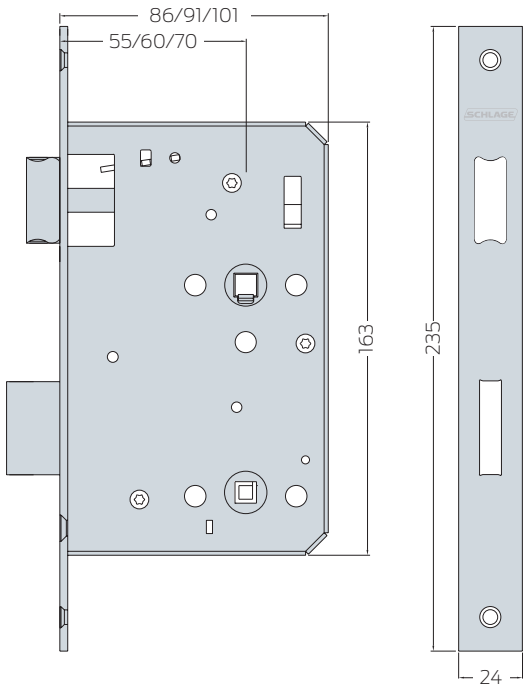

EL3040HD

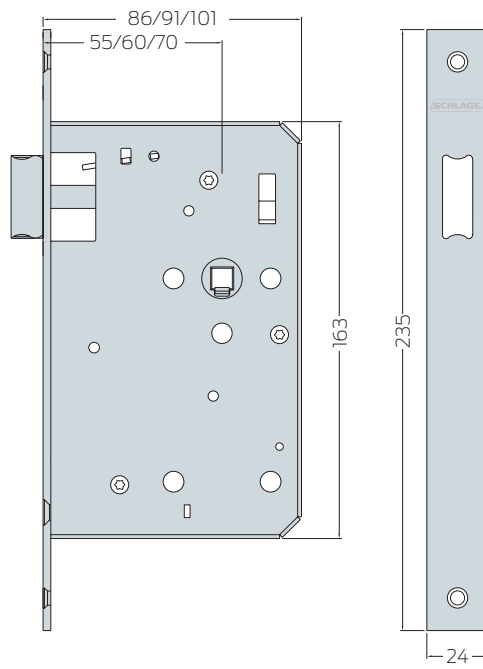

EL3050-HD

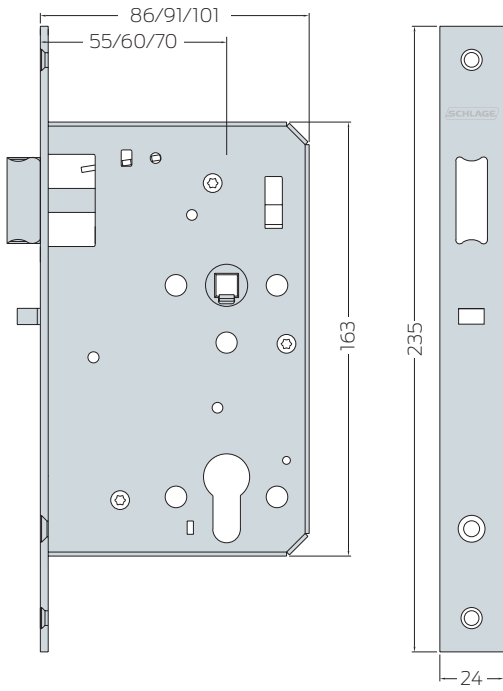

EL3060HD

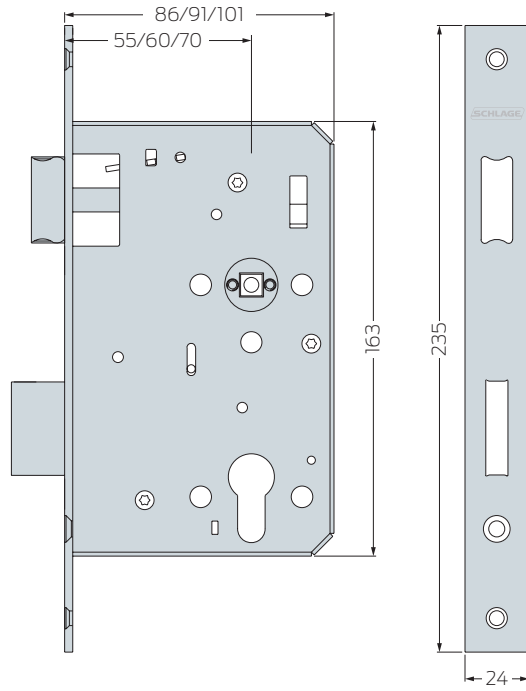

EL3060HD-AT

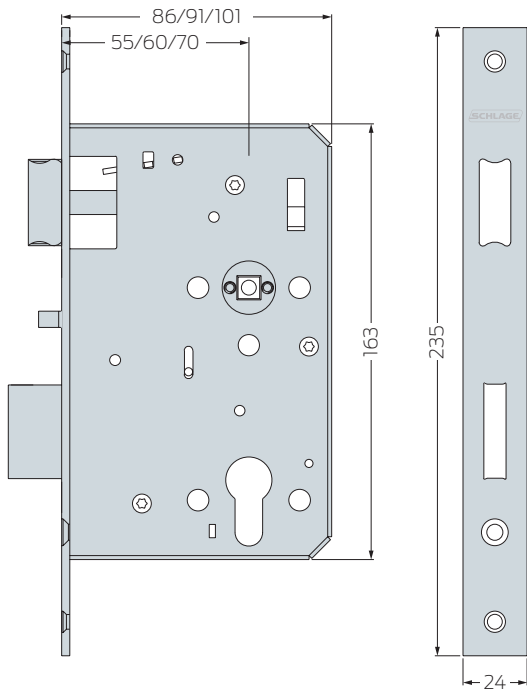

EL3070-HD

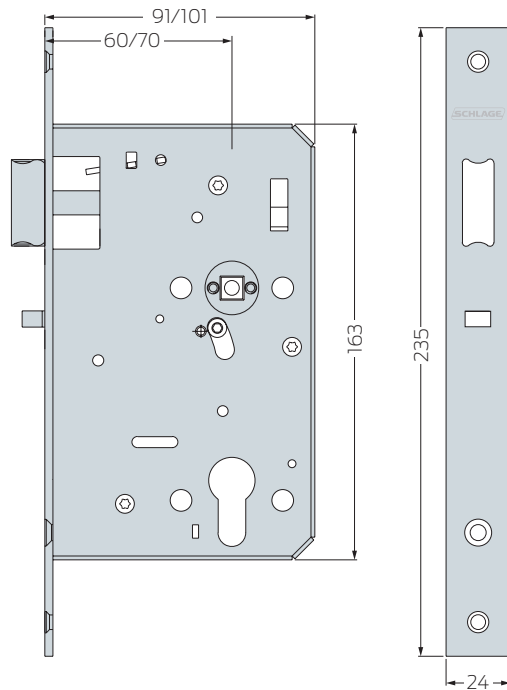

All measurements are in mm.